

This title plan shows the general position of the boundaries: it does not show the exact line of the boundaries. Measurements scaled from this plan may not match measurements between the same points on the ground. For more information see Land Registry Public Guide 7 - Title Plans.

This official copy shows the state of the title plan on 10.08.06 at 11.07.58. It may be subject to distortions in scale. Under s.67 of the Land Registration Act 2002, this copy is admissible in evidence to the same extent as the original.

Issued on 10 AUGUST 2006
This title is dealt with by Birkenhead (Old Market) District Land Registry.

© Crown Copyright. Produced by Land Registry. Further reproduction in whole or in part is prohibited without the prior written permission of Ordnance Survey. Licence Number GD272728.

H.M. LAND REGISTRY		TITLE NUMBER	
		MS 5815	
ORDNANCE SURVEY PLAN REFERENCE	COUNTY	SHEET	NATIONAL GRID
	LANCASHIRE		SD 3602
Scale: 1:1250			SECTION A
			© Crown copyright 1973

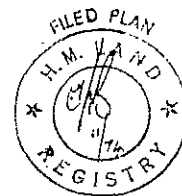
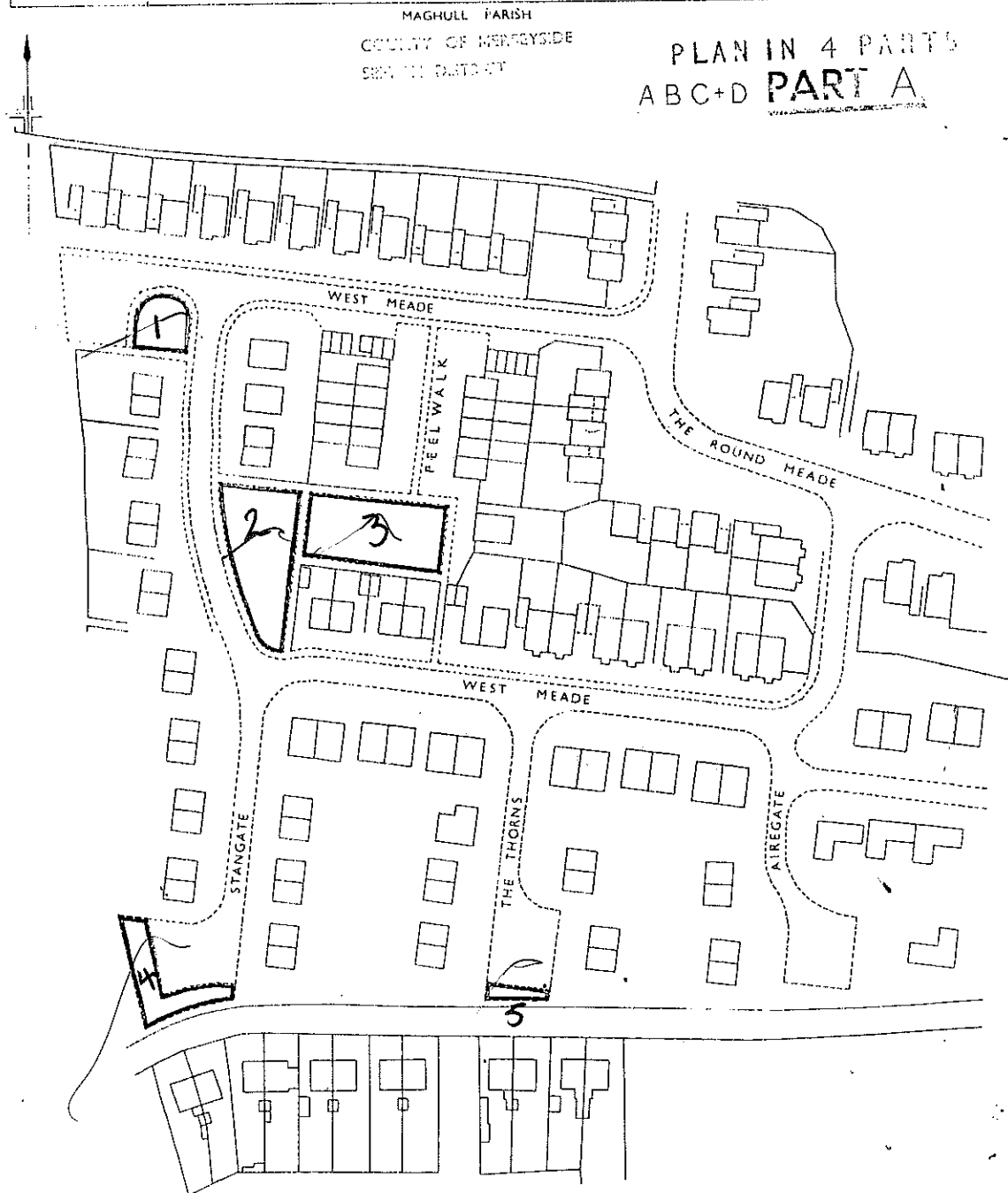

H.M. LAND REGISTRY		TITLE NUMBER	
		MS 5815	
ORDNANCE SURVEY PLAN REFERENCE	COUNTY	SHEET	NATIONAL GRID
	LANCASHIRE		SD 3702
Scale: 1/1250			SECTION B
© Crown copyright 1972			

PLAN IN 4 PARTS
ABC+D PART B

MAGHULL PARISH

COUNTY OF MERSEYSIDE
SEPTON DISTRICT

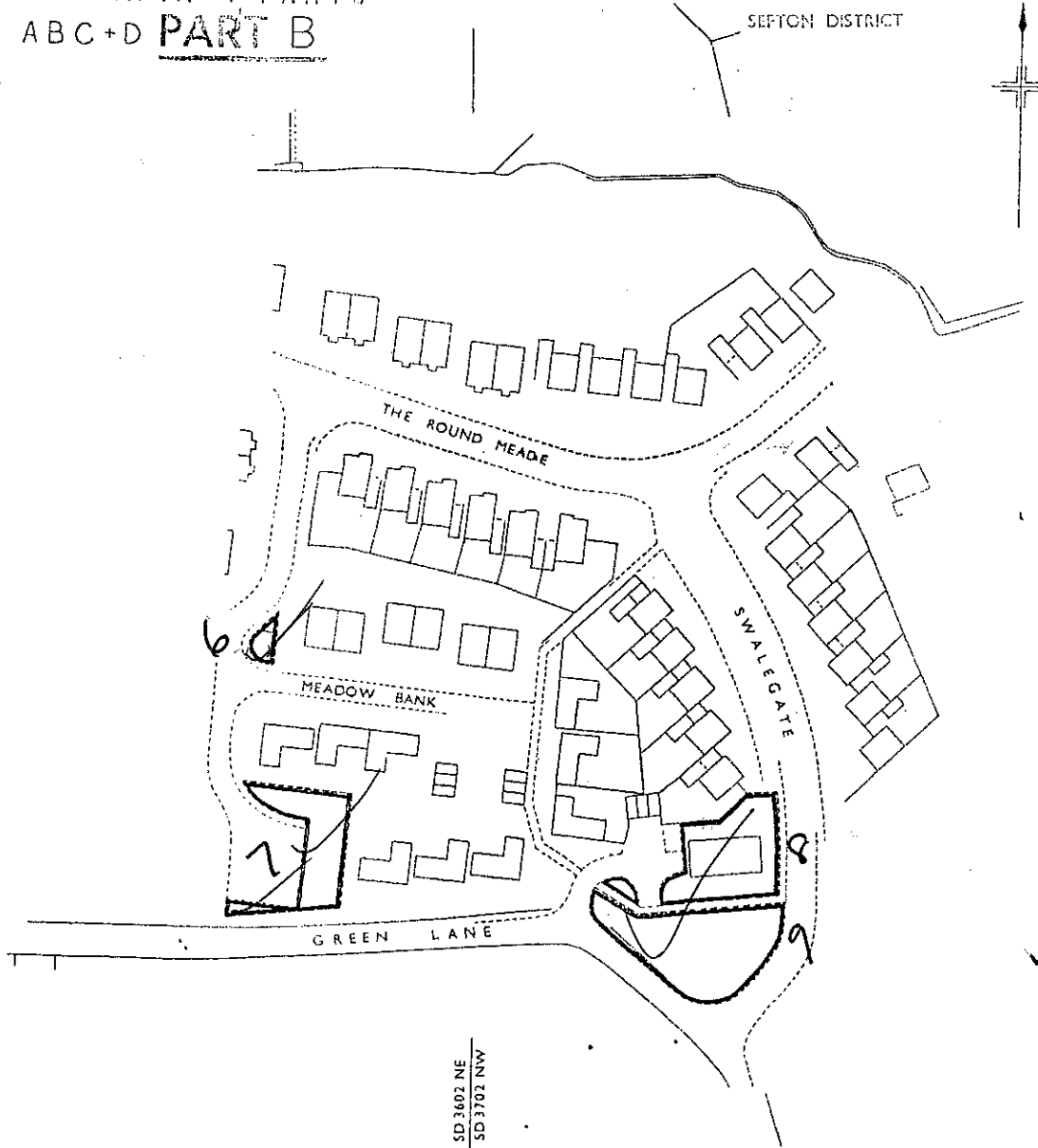

SD 3602 NE
SD 3702 NW



H.M. LAND REGISTRY		TITLE NUMBER	
		MS 501	
ORDNANCE SURVEY PLAN REFERENCE	COUNTY	SHEET	NATIONAL GRID
	LANCASHIRE		SD 3702
Scale: 1/1250			© Crown copyright 1973

4 PARTS
ABC+D PART C

MAGHULL PARISH COUNTY OF MERSEYSIDE
SEFTON DISTRICT

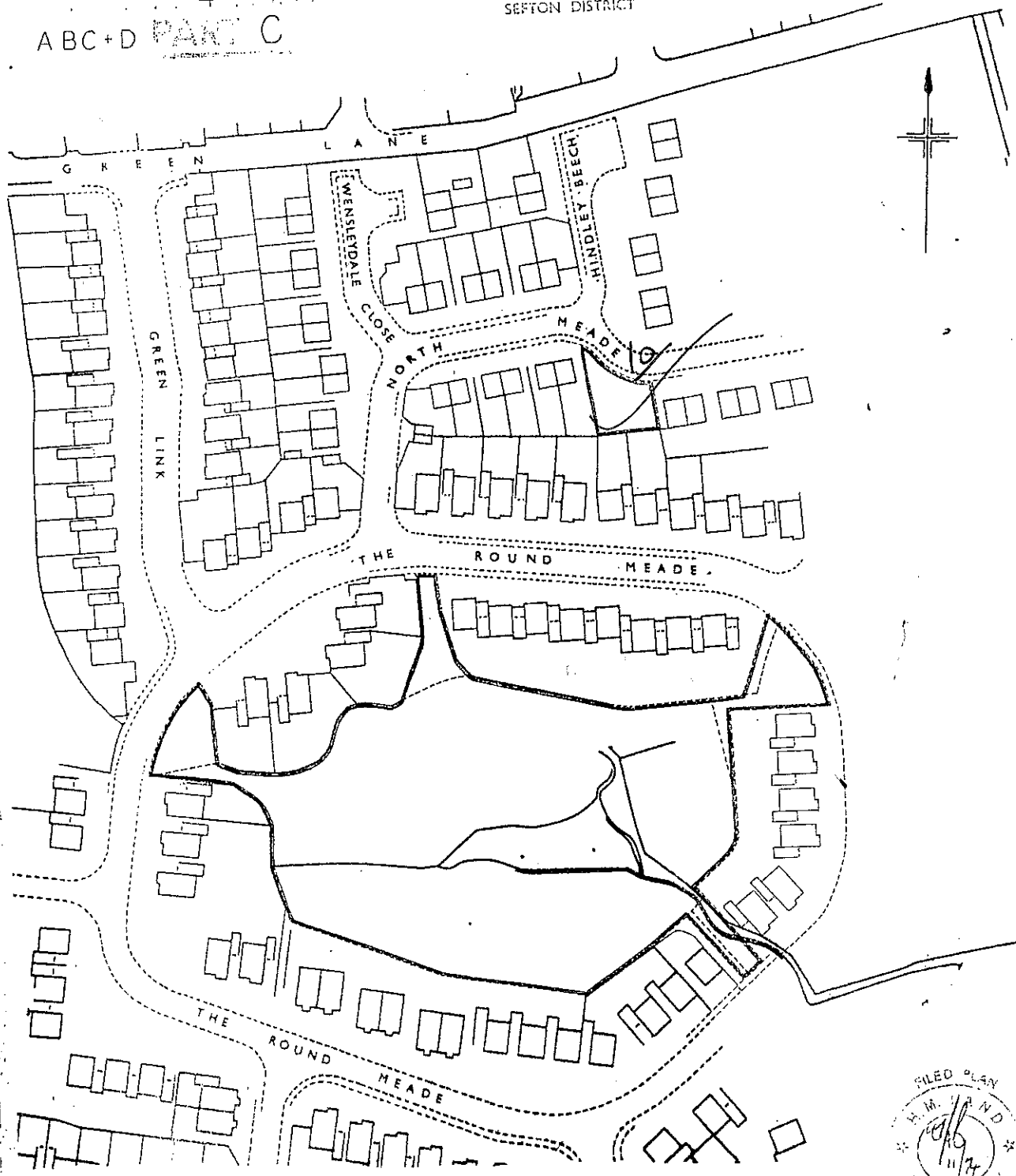

H.M. LAND REGISTRY			TITLE NUMBER	
			M50013	
ORDNANCE SURVEY PLAN REFERENCE	COUNTY	SHEET	NATIONAL GRID	SECTION
	MERSEYSIDE		SD 3702	C
Scale: 1:1250		SEFTON DISTRICT	© Crown copyright 1974	

PLAN IN 4 PARTS
ABC+D PART D

MAGHULL PARISH

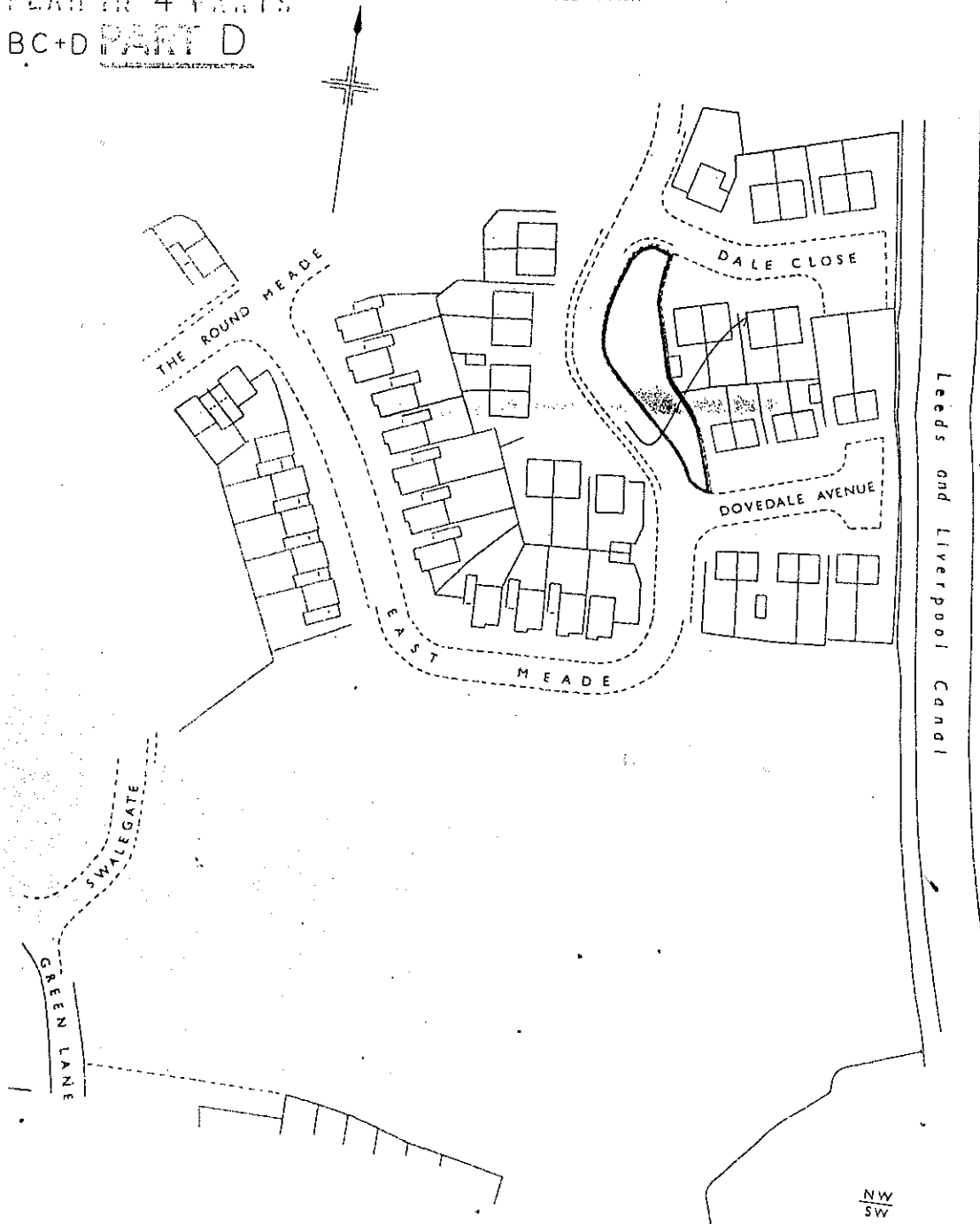

NW
SW

